

DO NOT GLUE THE CENTER W-1 RIB OR THE WOOD DOUBLERS IN PLACE UNTIL AFTER THE WING HALVES ARE JOINED TOGETHER. SEE INSTRUCTION BOOK.

Instant glue assembles a framework quickly but may not be good enough to withstand the vibration of a 1/4 scale engine if improperly used. Thin cyanoacrylate should only be applied to perfectly fitted joints, otherwise use gap-filling types. If you assemble with instant glue, we think it is a good idea to cover the framework with a normal slow dry glue like Sig-Bond and fill all of the joints on the outside. One mistake often made is inadequate amounts of glue on large mating surfaces. RIGHT WING MAIN FRAME. SEE THE INSTRUCTION BOOK FOR DETAILS.

THIS HALF OF THE DRAWING IS INTENDED ONLY FOR ASSEMBLY OF THE OTHER HALF OF THE WING. CROSS-SECTION VIEWS AND THE INSTRUCTION BOOK FOR CONSTRUCTION DETAILS.

but the outside wing sheeting must be glued to the ends of the webs as well as the webs must not just be glued to the spars. For example, the wing spar are joined A structure does not have full strength unless all of the parts are glued to each other. For example, the wing spar must be glued to the ends of the webs as well as the outside wing sheeting must be glued to the ends of the webs as well as the webs.

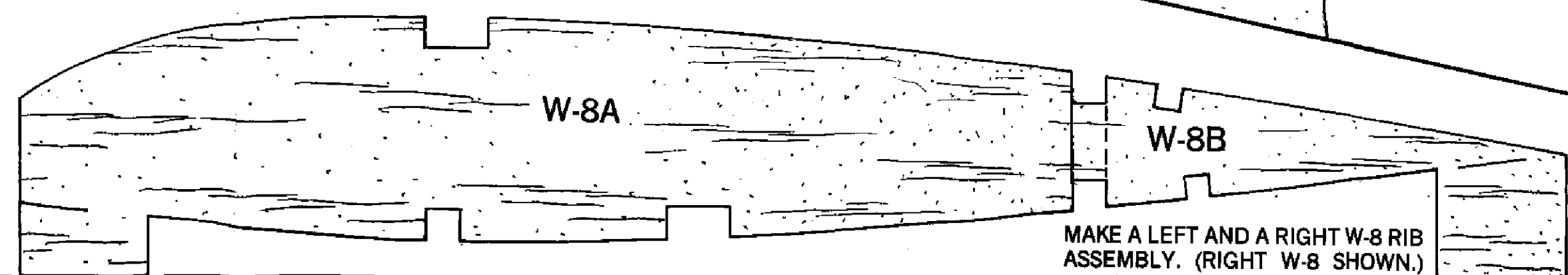
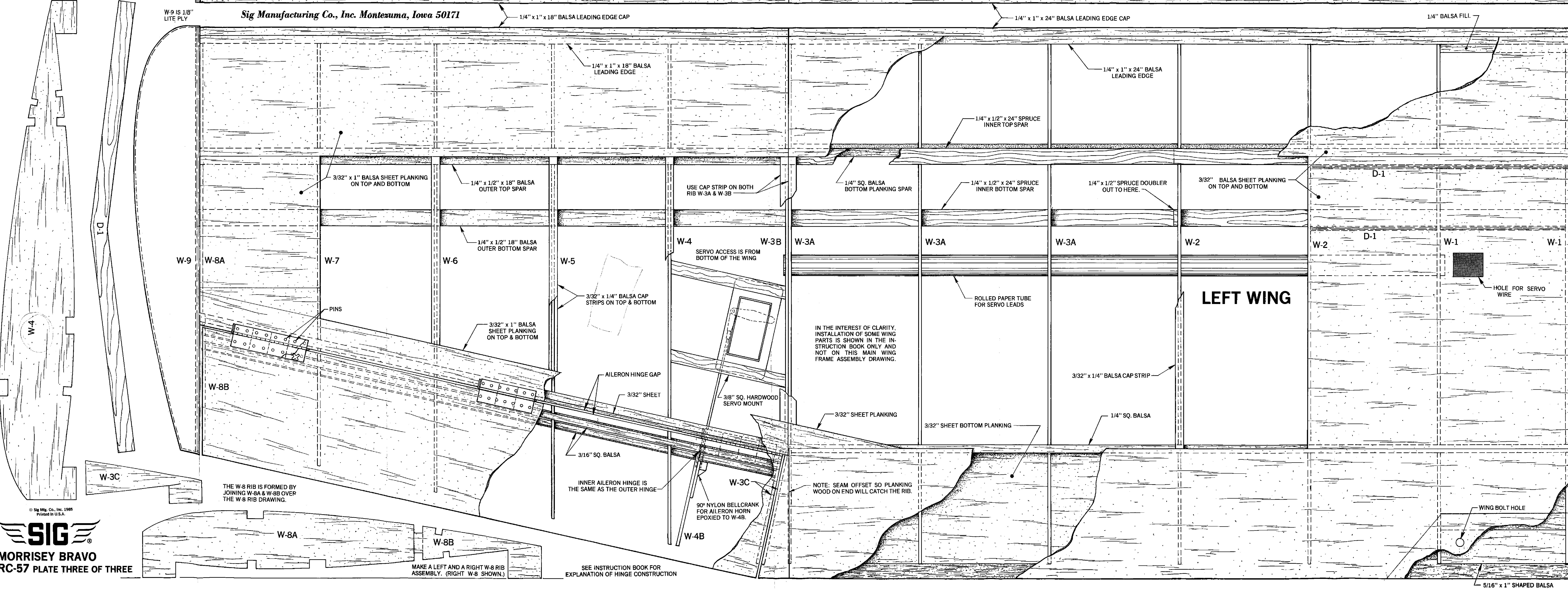

SEE INSTRUCTION BOOK FOR EXPLANATION OF HINGE CONSTRUCTION

THE W-8 RIB IS FORMED BY JOINING W-8A & W-8B OVER THE W-8 RIB DRAWING.

Sig Manufacturing Co., Inc. Montezuma, Iowa 50171

W-9 IS 1/8" LITE PLY